

200 MM THK. STRUCTURAL CONCRETE WITH
12 MMØ REINFORCEMENT BARS SPACED @
300 MM BOTHWAYS O.C.

75 MMØ PVC PIPE WEEPHOLE
STAGGERED 2000 MM HORIZONTAL,
1000 MM VERTICAL

300 MM THK. GROUTED RIPRAP

10 - 16 MMØ LONGITUDINAL MAIN BARS WITH
10 MMØ STIRRUPS SPACED @ 300 MM O.C.

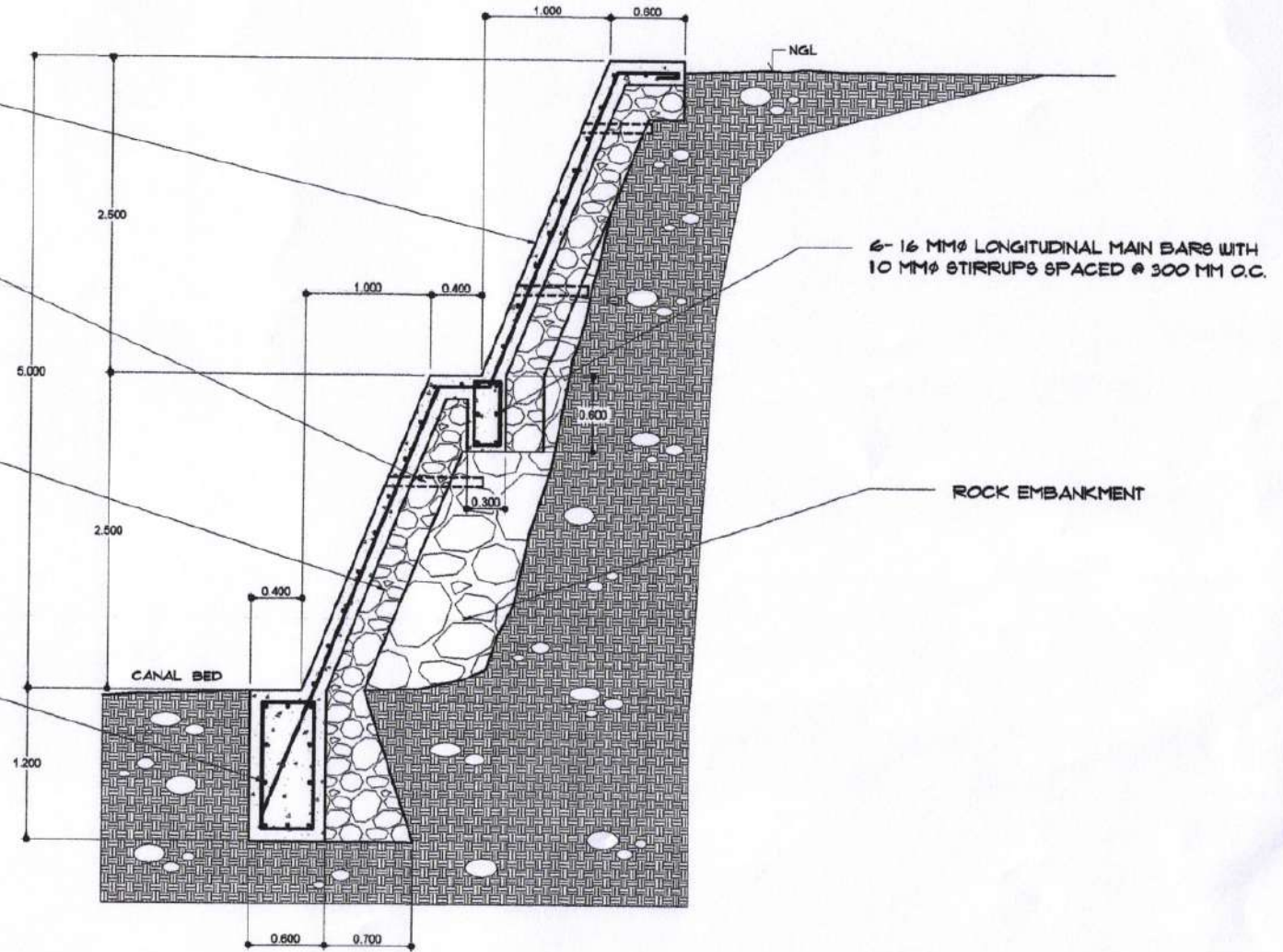

CROSS-SECTION

SCALE: 1:50M.



SORSOGON CITY
CITY ENGINEER'S OFFICE

PROJECT TITLE
PROPOSED CONSTRUCTION LINED CANAL/
SLOPE PROTECTION

LOCATION: BRGT. BUENAVISTA BACON DISTRICT SORSOGON

DRAWN BY:

FIO PERALTA
DRAFTING AIDE

NOTED BY:

ROEL D. DOMESTICO, RMP
CITY ENGINEER

APPROVED BY:

HON. MA. ESTER E. HAMOR
CITY MAYOR

SHEET CONTENT:

AS SHOWN

SHEET NO.

9

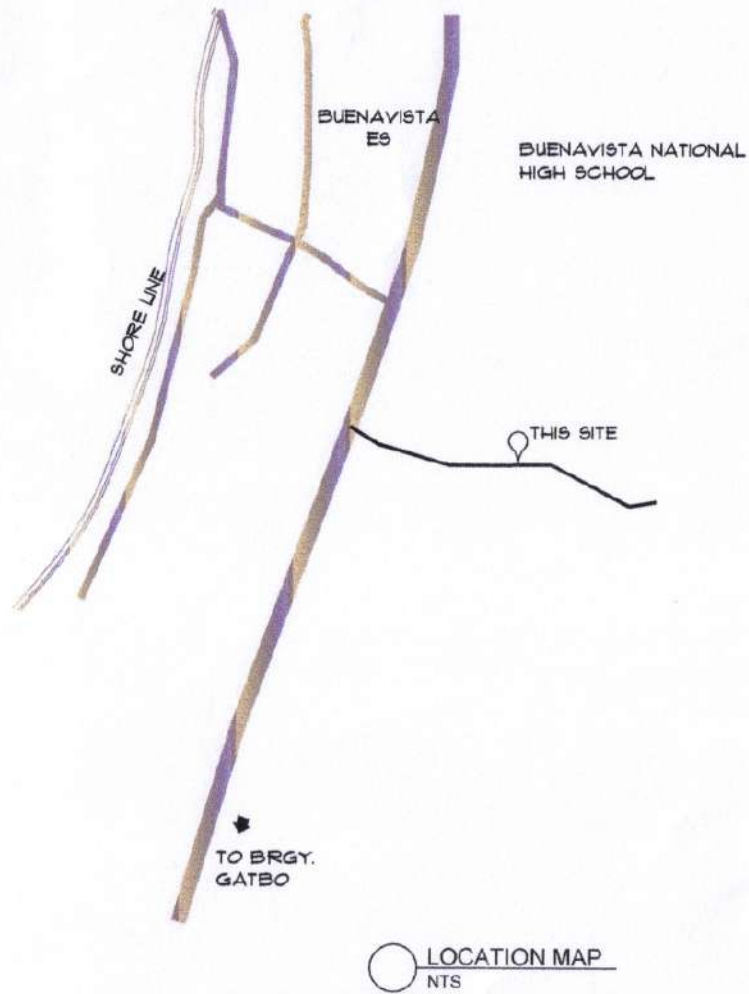

SORSOGON CITY
**CITY ENGINEERING
 OFFICE**

PROJECT TITLE:	DRAWN BY:	RECOMMENDED BY:	APPROVED BY:
PROPOSED CONSTRUCTION LINED CANAL/ SLOPE PROTECTION			
LOC: BRGY. BUENAVISTA, BACON DIST., SORSOGON CITY	ERWIN D. EQUIPADO CONST. & MAINT. GEN. FOREMAN	ROEL D. DOMERCE/RMP CITY ENGINEER	HON. MA. ESTER E. HAMOR CITY MAYOR