



NOTE:

- RESTORATION OF DISTURBED P.C.C.P INCLUDED

LOCATION/LAYOUT PLAN
SCALE: N. T. S

SORSOGON CITY	PROJECT TITLE:	DRAWN BY:	RECOMMENDING APPROVAL:	APPROVED BY:
 CITY ENGINEER'S OFFICE	CONSTRUCTION OF DRAINAGE SYSTEM	 ROY M. HUBILLA ENGINEERING AIDE	 ROEL D. DOMER, CE/RMP CITY ENGINEER	 HON. MA. ESTER E. HAMOR CITY MAYOR
	LOCATION: OLV, BRGY. PANGPANG, WEST DISTRICT, SORSOGON CITY			

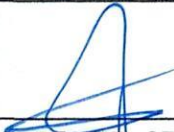
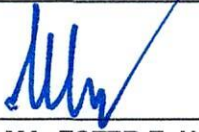
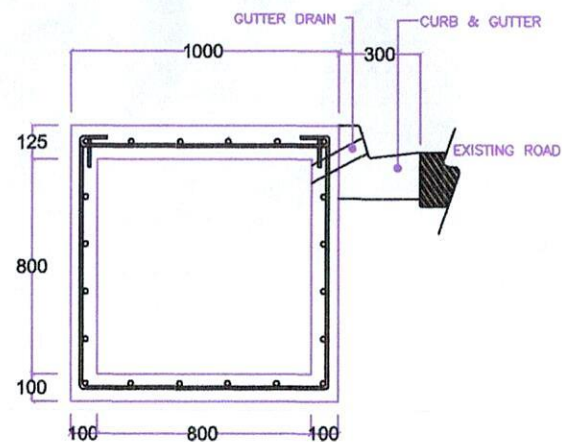

TYPICAL CANAL 1 SEC.
w/ FIXED COVER

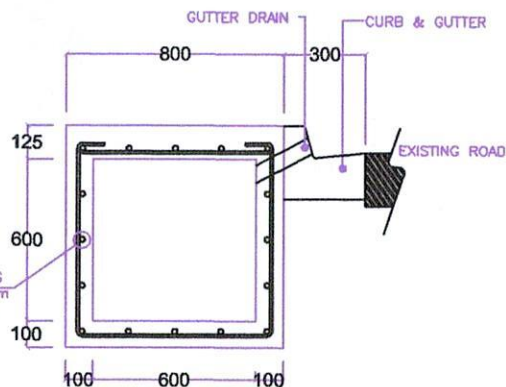

TYPICAL CANAL 2 SEC.
w/ FIXED COVER

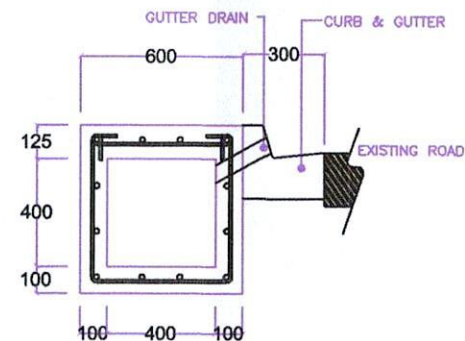

TYPICAL CANAL 3 SEC.
w/ FIXED COVER

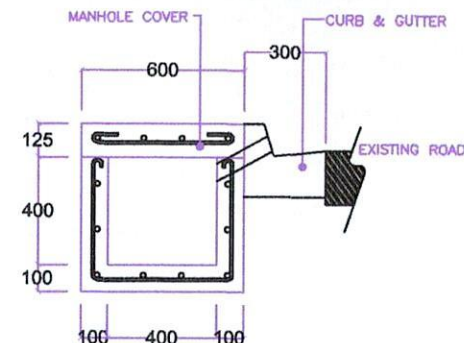

TYPICAL CANAL 3 SEC.
w/ MANHOLE COVER

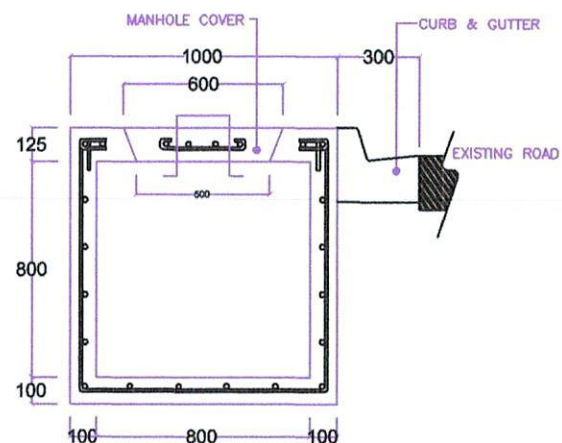

TYPICAL CANAL 1 SEC.
w/ MANHOLE COVER

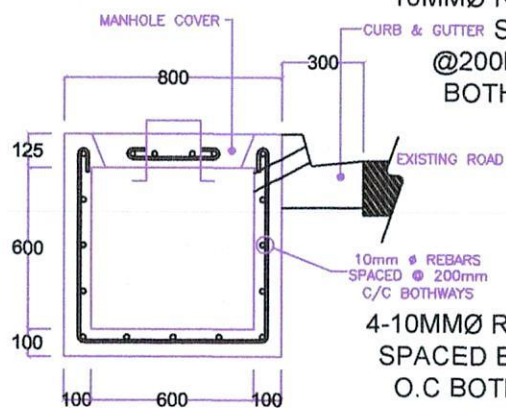

TYPICAL CANAL 2 SEC.
w/ MANHOLE COVER

10MMØ REBARS
SPACED
@200MM O.C
BOTHWAYS

4-10MMØ REBARS
SPACED EVENLY
O.C BOTHWAYS

R.C.P.C.
(CROSS PIPE)

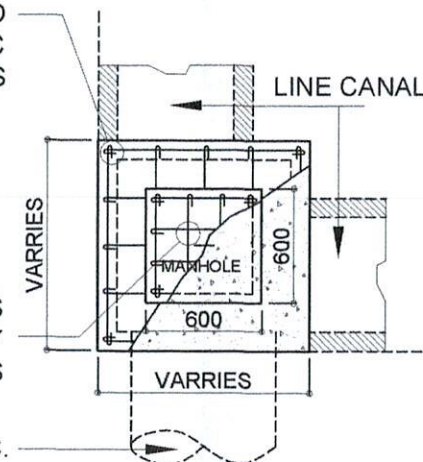

CATCH BASIN PLAN
W/ R.C.P.C.



SCALE:

N.T.S.

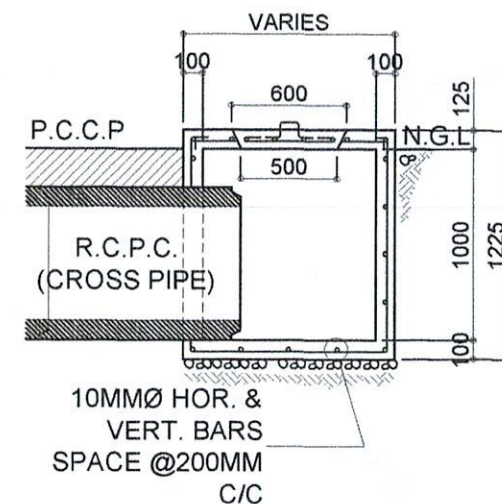

CATCH BASIN W/ R.C.P.C.
SECTION ELEVATION



PROJECT TITLE:
CONSTRUCTION OF DRAINAGE SYSTEM

LOCATION: OLV, BRGY. PANGPANG,
WEST DISTRICT, SORSOGON CITY

DRAWN BY:

ROY M. HUBILLA
ENGINEERING AIDE

RECOMMENDING APPROVAL:

ROEL D. DOMER, CE/RMP
CITY ENGINEER

APPROVED BY:

HON. MA. ESTER E. HAMOR
CITY MAYOR